

Tax Impact

New Fire Station Project

25 YEARS PRINCIPAL	INTEREST RATE	25 YEAR TOTAL	
		INTEREST	TOTAL PAYMENTS
\$ 1,691,880	3.750%	\$ 947,346	\$ 2,639,226

Estimated Tax Impact		
Assessed Value	First Year Principal and Interest Payment (2018)	
\$260,000	Year 1 Principal and Interest	\$59.65
\$280,000	Year 1 Principal and Interest	\$64.24
\$300,000	Year 1 Principal and Interest	\$68.83
Assessed Value	Last Year Principal and Interest Payment (2042)	
\$260,000	Last Year Principal and Interest	\$53.45
\$280,000	Last Year Principal and Interest	\$57.56
\$300,000	Last Year Principal and Interest	\$61.67

Construction Budget Summary

General Requirements	\$	137,500
Site Work	\$	246,500
Concrete Foundation / Slabs	\$	123,000
Metal Bldg. / Structural Steel	\$	338,850
Building Insulation	\$	44,825
Doors & Windows	\$	68,750
Interior Finishes	\$	105,830
Carpentry	\$	35,200
Mechanical Systems	\$	90,450
Electrical Systems	\$	114,400
Fire Protection Systems	\$	100,000
Subtotal	\$	1,405,305
5% Owners Contingency	\$	70,265
OH&P	\$	84,320
Architectural/Engineering Fees	\$	81,120
Civil Engineering Fee	\$	14,790
Project Soft Costs	\$	36,080
Total Cost Estimate	\$	1,691,880

On average, the new fire station will cost each taxpayer approximately \$ 1.15 per week.

First Floor Legend

Single Story Building

1A-Lobby	1H-Medical Storage
1B-Radio	1J-Restroom
1C-Office	1K-EMOC
1D-Conference	1L-Training
1E-Men's Locker Room	1M-Mech./Sprinkler
1F-Woman's Locker Room	1N-Electrical Room
1G-Janitors Closet	1P-Kitchen
	1Q-Apparatus Bays

Proposed Floor Plan

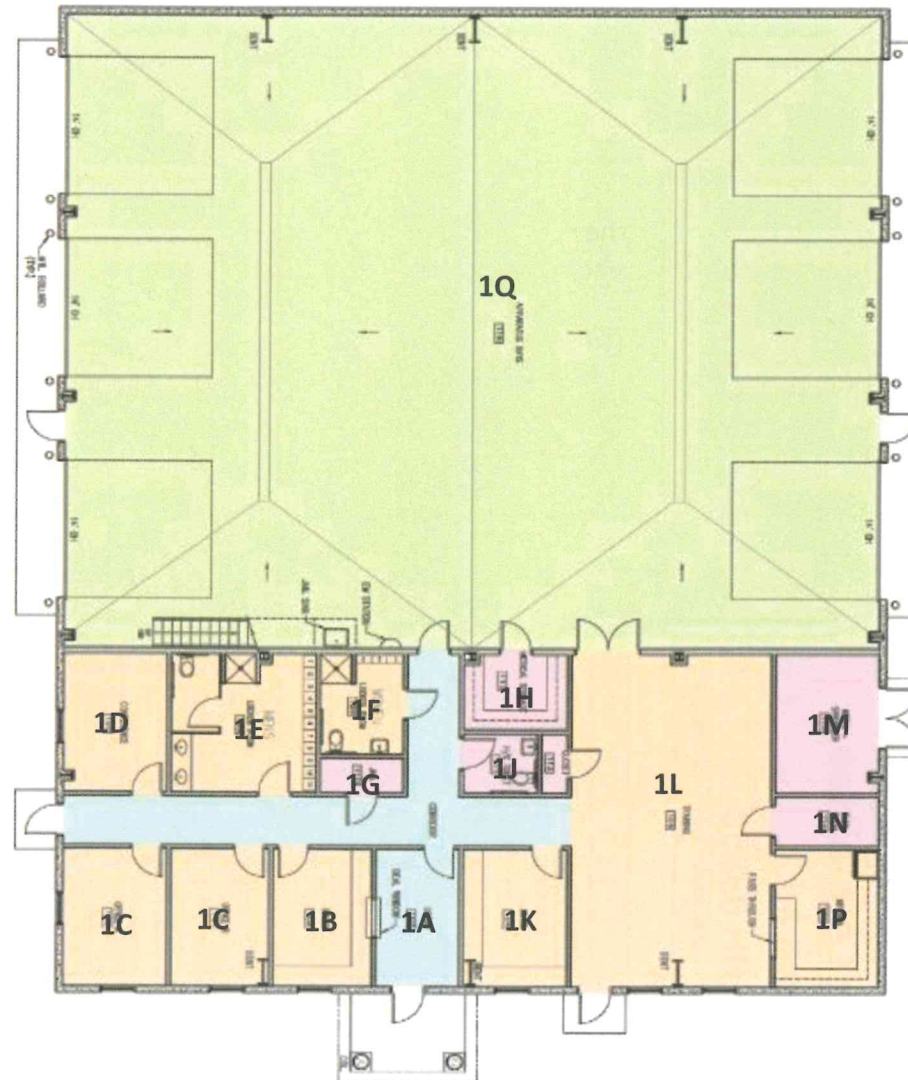

Questions & Answers

Q. Life expectancy of the new station?
A. 40 years +.

Q. Does the new facility have room for growth for additional apparatus?
A. Yes, on the west side of the proposed station.

Q. Does the \$ 1,691,880 estimated cost include any revenue from the sale of the existing fire station building?
A. No. However, the NFSBC does recommend selling the existing station, with the proceeds used to offset the cost of the new station.

Q. Will the project cost go over \$ 1,691,880?
A. No. A fixed price, not-to-exceed contract will be signed with the General Contractor.

Q. When was the first time the Town brought forward a fire station warrant?
A. 2006

Q. Why has the cost of the new station gone up?
A. Subcontractor and material prices increase an average of 7-12% per year.

Site Plan

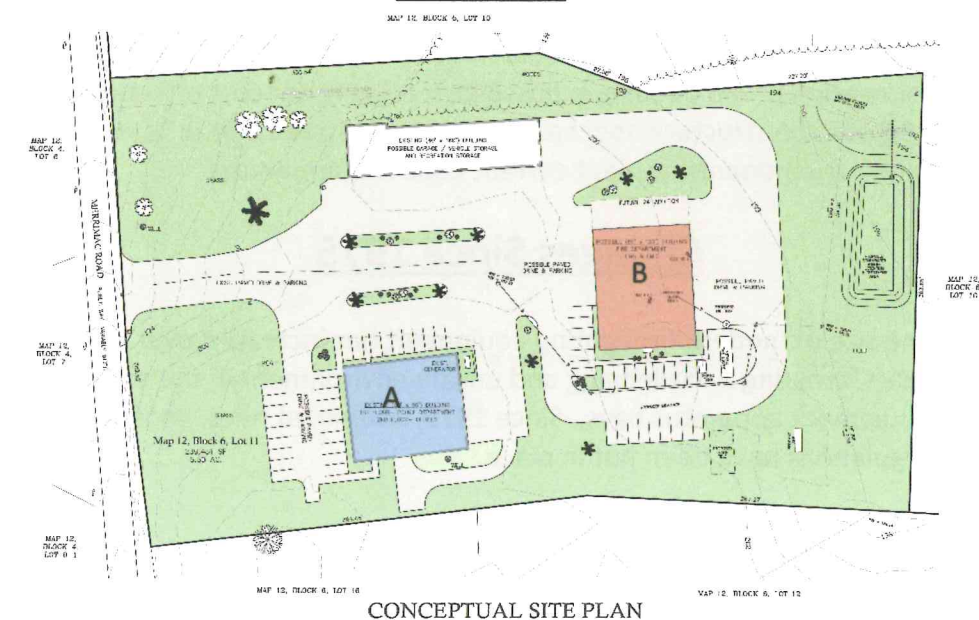

A = Existing Police Station
B = Proposed Fire Station